

Angular Contact Ball Bearings

Brass cage angular contact ball bearing-7209 BECBM

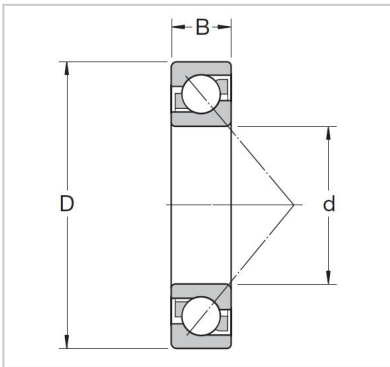

Abutment and fillet dimensions

| | |
|---------|-------------------|
| Db max. | 7209 BECBM |
| Da max. | - |
| da min. | 45 |
| rb max. | 85 |
| ra max. | 19 |

Dimensions

| | |
|-----------|--------|
| a | 38 |
| r3,4 min. | 28.5 |
| r1,2 min | 1.22 |
| D1 | 10 000 |
| d2 | 10 000 |
| d1 | 0.42 |

Mass

| | |
|----|------|
| KG | 60.9 |
|----|------|

Speed ratings r/min

| | |
|-----------------|------|
| Limiting speed | 52.7 |
| Reference speed | 70.2 |

Fatigue load limit

| | |
|-------|-----|
| Pu kN | 1.1 |
|-------|-----|

Basic load ratings KN

| | |
|--------------|-----|
| dynamic C kN | 0.6 |
| static Co kN | 37 |

Basic design bearing

| | |
|------|------|
| B mm | 52 |
| D mm | 78 |
| d mm | 80.8 |

Basic design bearing

| | |
|-------------------------------|-----|
| 1 | |
| Designations | |
| Universally matchable bearing | 0.6 |